

DETAIL A
SCALE
1:5

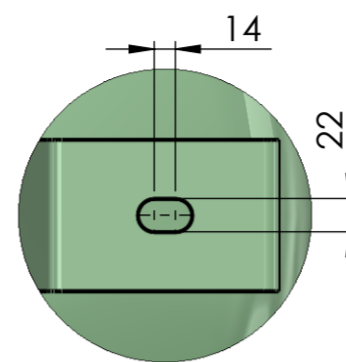
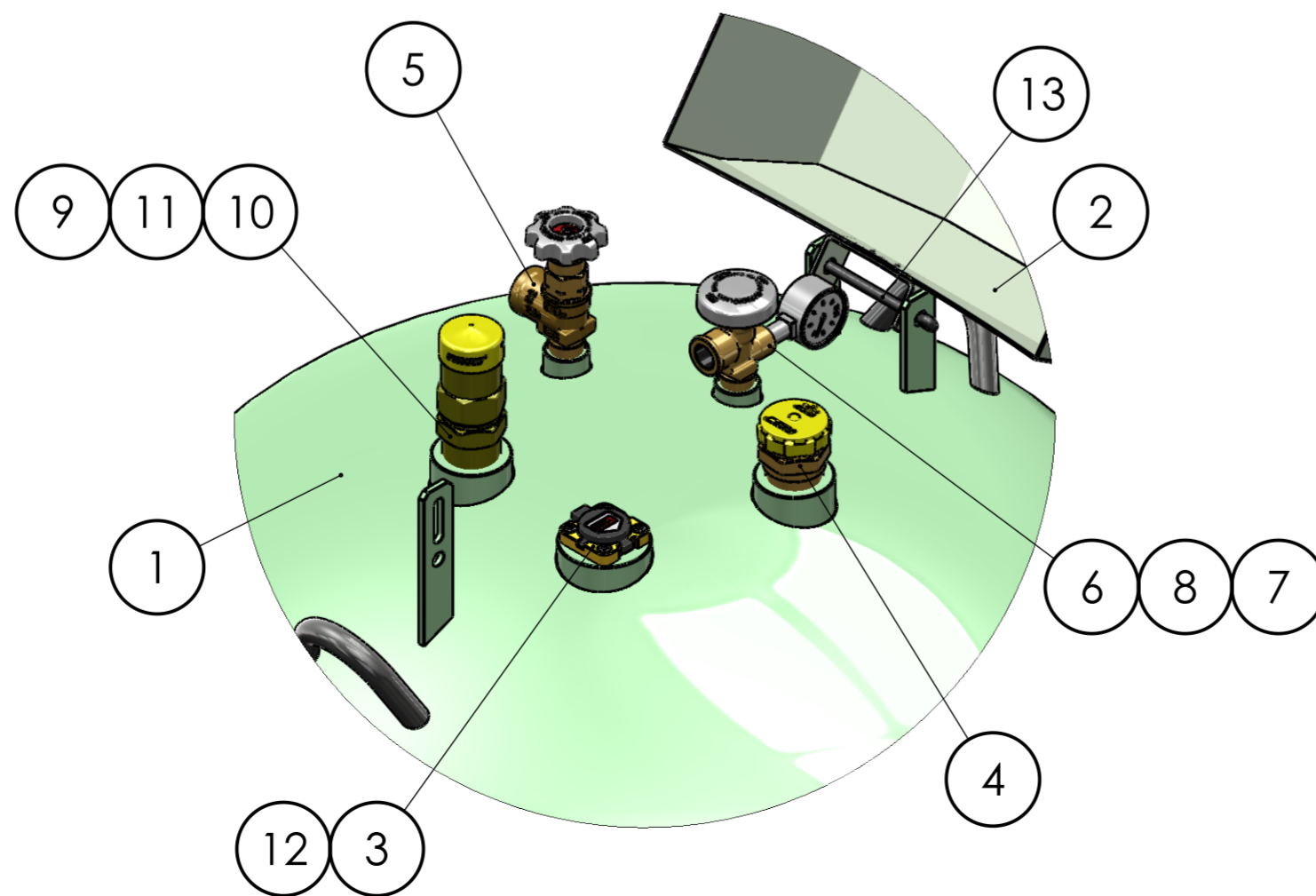

Table of tank volumes and basic dimensions								
D	Volume	A	B	E	F	P	R	Weight
800	940l	1620	2362	300	600	100	600	227
800	760l	1250	1992	300	600	100	600	*190
800	580l	890	1632	300	600	100	600	*155
800	540l	810	1552	300	600	100	600	*147
1000	1430l	1500	2353	350	700	100	800	*298
1000	1230l	1250	2103	350	700	100	800	*267
1000	960l	890	1743	350	700	100	800	*223
1000	900l	810	1663	350	700	100	800	*213
1200	2020l	1400	2360	375	750	150	1000	*391
1200	1860l	1250	2210	375	750	150	1000	*369
1200	1450l	890	1850	375	750	150	1000	*315
1200	1370l	810	1770	375	750	150	1000	*304
1250	2220l	1400	2386	400	800	150	1000	*404
1250	2040l	1250	2236	400	800	150	1000	*381
1250	1600l	890	1876	400	800	150	1000	*325
1250	1500l	810	1796	400	800	150	1000	*313

SCALE
1:5



Bill of material					
Pos	Name	Pololovar	Preparations	Comment	Qt.
1	OVERGROUND TANK				1
2	PLASTIC HOOD				1
3	LEVEL GAUGE	C-FLEX ELG	MOSAZ / BRASS	JUNIOR	1
4	FILLING VALVE	L7579CT	MOSAZ / BRASS	5/4"M.NPT	1
5	WITHDRAWAL VALVE	7550PX	MOSAZ / BRASS	3/4"M.NPT	1
6	SERVICE VALVE	9101DK	MOSAZ / BRASS	3/4"M.NPT	1
7	PIPE TUBE	0906-450	MOSAZ / BRASS		1
8	MANOMETER 17,2 bar	1001440	OCEL - POZINK	1/4" M.NPT	1
9	PRESSURE RELIEF VALVE EXT.	RS3131	MOSAZ / BRASS	15,6bar	1
10	CHEK-LOK	CD31T	MOSAZ / BRASS	5/4"M.NPT	1
11	GASKET FOR PRESSURE VALVE	CD31-8	MOSAZ / BRASS		1
12	HEX. SOCKET HEAD SCREW	M6x25	A2	ISO 4762	4
13	SPLIT PIN	8x110	OCEL - POZINK	ISO 1234	1

Technical data			
DESIGN CODE	EN ISO 12542, AD2000, PED 2014/68/EU		
WORKING FLUID	PROPAN / BUTAN ACCORDING TO DIN 51622 / EN589		
MAX. WORKING PRESSURE	15,6 bar	16,7 bar	17,6 bar
RELIEF VALVE SET PRESSURE	15,6 bar	16,7 bar	17,6 bar
TESTING PRESSURE	22,3 bar	23,9 bar	25,2 bar
MAX./MIN ALLOW. OPER. WALL TEMPERATURE	-20(-40)/+40 °C	-20/+45 °C	-20(-30)/+50 °C
CORROSION ALLOWANCE	0	0	0
MAXIMUM FILLING	85% (82%,87%)	85% (82%,87%)	85% (82%,87%)
WELD FACTOR	1	1	1
MATERIAL	CARBON STEEL		
WELDED JOINTS EVALUATION ACCORDING TO AD-HP0			
ADDITIONAL WELDING MATERIALS	WELDS 135 - WIRE 1,2mm EN ISO 14341_A		
	WELDS 121 - WIRE 3,0mm EN ISO 14171_A		
	WELDS 141 - WIRE 2,0mm EN ISO 636_A		
SURFACE FINISH	SAND BLASTED Sa 2,5		
	POLYURETHANE COATING MIN. 120mik.		
	RAL 9010, RAL 6019, RAL 258 010		

1	Původní provedení	12.12.2023	HLAVÁČEK H.	TRPIŠOVSKÝ V.
Rev.	Popis revize	Datum	Kreslil	Schválil
Tabulka revizí				
Formát: A2	Měřítko: 1:10	Promítání: 	Poznámky:	Tolerance: ISO 2768-mK, ISO 8015
			List: 1	Listů: 1
			Název: Nadzemní nádrž	Hmot.: 227.4
			Název(EN): Overground tank	Revize: R1
			Číslo výkresu: V0002574	